

**WV**  
**Queen**



Panel Foot Wallbed

**Standard**  
Cabinet - 50  
65 x 90 x 17 (86)  
Straight Top  
Flat Headboard

**Supreme**  
Cabinet - S50  
70 x 90.5 x 24.5 (93)  
Wrap Crown  
Shelf Headboard  
(only 85" piers)

**Premium**  
Cabinet - Z50  
75 x 90x 20 (92)  
Straight Top  
Shelf Headboard  
Interior Bookcases

**Deluxe**  
Cabinet - X50  
75 x 90x 25 (92)  
Curved Top  
Shelf Headboard  
Interior Bookcases

**Ultra**  
Cabinet - U50  
80 x 90.5 x 23 (92)  
Wrap Crown  
Shelf Headboard  
Interior Bookcases  
(only 85" piers)



**Madison (MV50)**  
Rotating Bar Support Leg  
68.5 x 92 x 18.5 (87)  
Can only take 85" tall piers  
Standard Cabinet Only



**Standard Cabinet also available in: FULL - 46: 59x17x85 (86)**



nickel bar    bronze bar    bridge nickel    bridge bronze    bridge black    bridge brass    cody black    cody nickel    cody bronze    cody gold



\* Indicates a upgraded paint finish fee of 10%

Stain finishes are included with no additional fee

**NIGHTSTAND PIER with DOOR**  
2 drawers, pull out tray table,  
Open shelf and upper door



PUF 24x85  
PUQ 24x90

**NIGHTSTAND PIER CABINET**  
2 drawers, pull out tray table,  
With open adjustable shelves

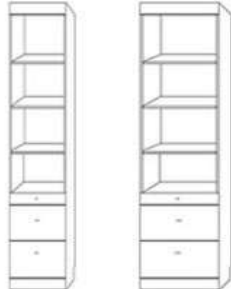

NFS 16x85 PNF 24x85  
NGS 16x90 PNG 24x90

**LATERAL FILES PIER CABINET**  
2 file drawers, pencil drawer  
With open adjustable shelves

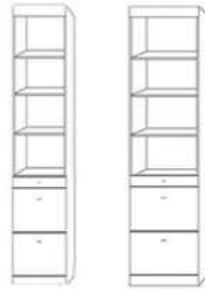

LFS 16x85 PLF 24x85  
LGS 16x90 PLQ 24x90

**3 DRAWER PIER CABINET**  
3 drawers with open adjustable shelves

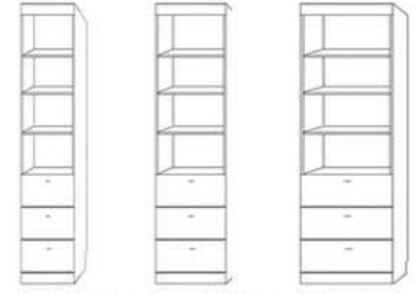

TFS 16x85 PTF 24x85 PGF 32x85  
TGS 16x90 PTQ 24x90 PGQ 32x90



**WARDROBE**  
3 drawers, upper  
door & clothes valet

PWF 24x85  
PWG 24x90

**FILE WARDROBE**  
2 lateral file drawers,  
Pencil drawer with upper  
door & clothes valet



PXF 24x85  
PXG 24x90



**3 DRAWER w/ DOOR**  
3 drawers, upper door

WFS 16x85  
WGS 16x90

**FILE WITH w/ DOOR**  
2 lateral file drawers,  
Pencil drawer  
with upper door



XFS 16x85  
XGS 16x90

**GUEST WARDROBE**  
3 drawers with  
2 upper doors  
& clothes valet

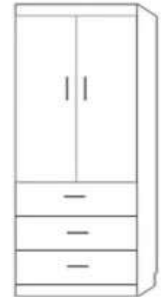

PWU 32x85

**ROLLING DESK CART**  
On castors, File Cart  
Rolls underneath.  
Finished open back



DC - 63w x 20d x 31h

**ROLLING FILE CART**  
Lateral file drawer,  
medium drawer and a  
pencil drawer on castors.  
Fits underneath Hidden  
Desk beds and Desk Cart.  
Finished back



FC 16x16x29

**NIGHTSTAND**  
Flush sides on  
top, baseboard  
notch. 2  
drawers with a  
pencil drawer



NS 24x16x29

**BOOKCASE**



BFS 16x85 PBF 24x85  
BGS 16x90 PBQ 24x90  
BFL 32x85  
BQL 32x90

**PLEASE NOTE**

**Rollover Leg Bed Piers**  
Only available in 85" height  
Wrap molding makes piers  
18.5" & 25.5" in total width

**DOOR CABINET**

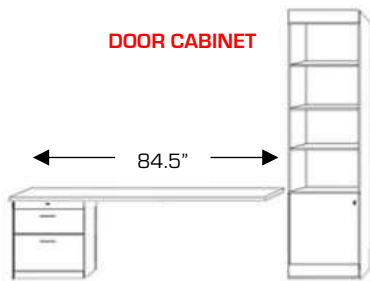

FD - Desk Base  
STRAIGHT Desktop



PCF 24x85  
PCQ 24x90



DFS 16x85  
DQS 16x90

**2 DOOR CABINET**

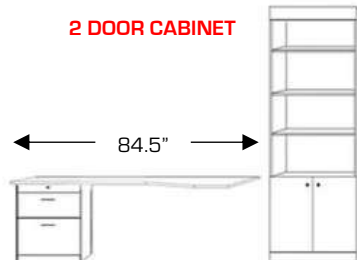

LD - Desk Base  
with SHAPED Desktop



DFL 32x85  
DGL 32x90

48" long  
drop down  
desk with  
adjustable  
shelves



**MURPHY DESK** PAF 24x85

**Extra's & Add-Ons**

- Add LED Light Bar & USB Charging Station
- Add Extra Shelves
- Add Clothes Hanging Rod to any pier
- Other :

**About the NorCal Collection**

This collection is made in the USA with sustainable hardwoods with veneers. This collection uses "through bolts", has a mattress platform that has internal support struts, and a foundation with 20' of structure material. The NorCal collection uses a piston lift system that has been tested for conditions for 16k cycles with no noticeable change in performance, and the pistons are guaranteed for life.