

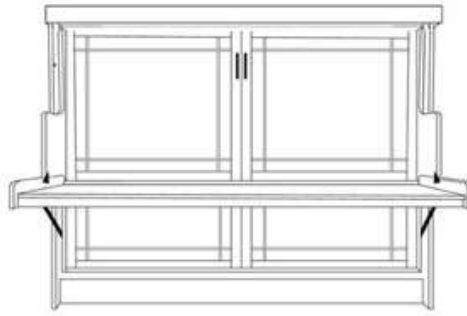

Vertical Inverness Desk Bed (IVB50)
 68 x 49 x 90 (82)
 desk = 23.5 x 61

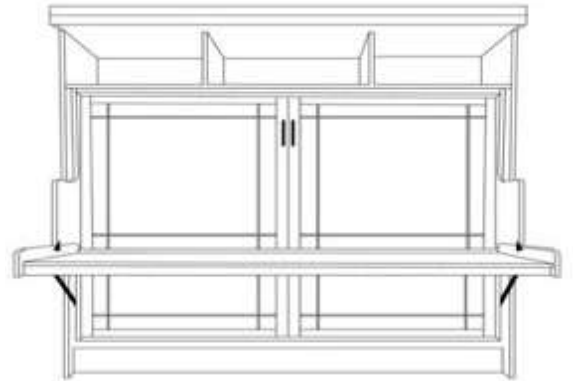

Horizontal Inverness Desk Bed (IB50)
 88.5 x 46.5 x 90 (70)
 desk = 23.5 x 82



Horizontal Inverness Desk Bed w/hutch (IW50)
 88.5 x 46.5 x 76.5 (70)
 desk = 23.5 x 82

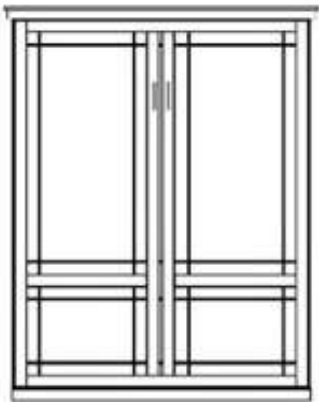

Glen Ellyn (GV50)
 Rotating Bar Support Leg
 68.5 x 92 x 18.5 (87)
 Can only take 85" tall piers
 Standard Cabinet Only



★ ADD LIGHTS and a USB charger to any Wallbed! ★



nickel bar bronze bar bridge nickel bridge bronze bridge black bridge brass cody black cody nickel cody bronze cody gold



natural pebble maple bark sunset hazelnut

* Indicates a upgraded paint finish fee of 10%

Stain finishes are included with no additional fee



caramel cognac espresso cinnamon white * alabaster * cobalt blue *

NIGHTSTAND PIER with DOOR
2 drawers, pull out tray table,
Open shelf and upper door



PUF 24x85
PUQ 24x90

NIGHTSTAND PIER CABINET
2 drawers, pull out tray table,
With open adjustable shelves

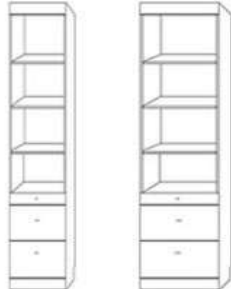

NFS 16x85 PNF 24x85
NGS 16x90 PNG 24x90

LATERAL FILES PIER CABINET
2 file drawers, pencil drawer
With open adjustable shelves

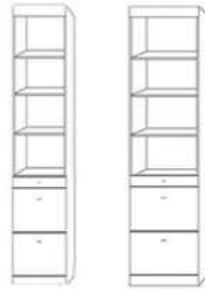

LFS 16x85 PLF 24x85
LGS 16x90 PLQ 24x90

3 DRAWER PIER CABINET
3 drawers with open adjustable shelves

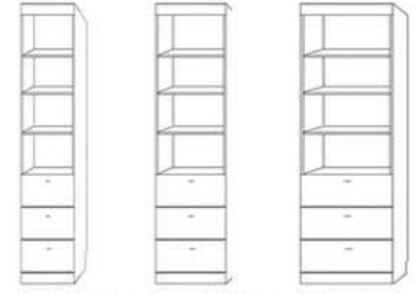

TFS 16x85 PTF 24x85 PGF 32x85
TGS 16x90 PTQ 24x90 PGQ 32x90



WARDROBE
3 drawers, upper
door & clothes valet

PWF 24x85
PWG 24x90



FILE WARDROBE
2 lateral file drawers,
Pencil drawer with upper
door & clothes valet

PXF 24x85
PXG 24x90



3 DRAWER w/ DOOR
3 drawers, upper door

WFS 16x85
WGS 16x90



FILE WITH w/ DOOR
2 lateral file drawers,
Pencil drawer
with upper door

XFS 16x85
XGS 16x90

GUEST WARDROBE
3 drawers with
2 upper doors
& clothes valet

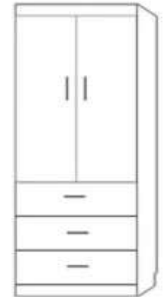

PWU 32x85

PLEASE NOTE
Rollover Leg Bed Piers
Only available in 85" height
Wrap molding makes piers
18.5" & 25.5" in total width

Desk Bed no Hutch
Height of piers matches
height of the wallbed

ROLLING DESK CART
On castors, File Cart
Rolls underneath.
Finished open back



DC - 63w x 20d x 31h

ROLLING FILE CART
Lateral file drawer,
medium drawer and a
pencil drawer on castors.
Fits underneath Hidden
Desk beds and Desk Cart.
Finished back



FC 16x16x29

NIGHTSTAND
Flush sides on
top, baseboard
notch. 2
drawers with a
pencil drawer



NS 24x16x29

BOOKCASE

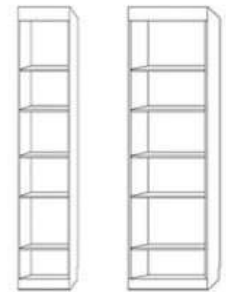

BFS 16x85 PBF 24x85
BGS 16x90 PBG 24x90
BFL 32x85
BQL 32x90

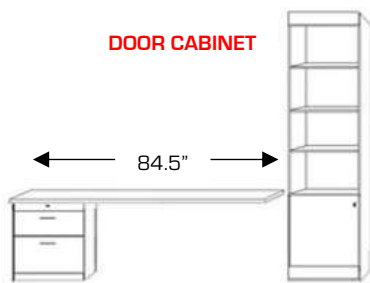

DOOR CABINET

84.5"

FD - Desk Base
STRAIGHT Desktop



PCF 24x85
PCQ 24x90



DFS 16x85
DQS 16x90

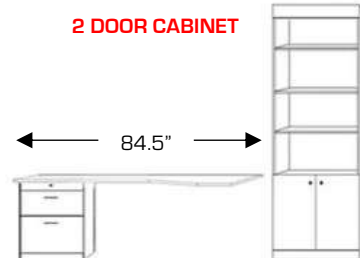

2 DOOR CABINET

84.5"

LD - Desk Base
with SHAPED Desktop



DFL 32x85
DGL 32x90



48" long
drop down
desk with
adjustable
shelves

MURPHY DESK PAF 24x85

Extra's & Add-Ons

- Add LED Light Bar & USB Charging Station
- Add Extra Shelves
- Add Clothes Hanging Rod to any pier
- Other :

About the NorCal Collection

This collection is made in the USA with sustainable hardwoods with veneers. This collection uses "through bolts", has a mattress platform that has internal support struts, and a foundation with 20' of structure material. The NorCal collection uses a piston lift system that has been tested for conditions for 16k cycles with no noticeable change in performance, and the pistons are guaranteed for life.