

**BV Queen**  
Panel Foot Wallbed

**Standard**  
Cabinet - 50  
65 x 90 x 17 [86]  
Straight Top  
Flat Headboard

**Supreme**  
Cabinet - S50  
70 x 90.5 x 24.5 [93]  
Wrap Crown  
Shelf Headboard  
(only 85" piers)

**Premium**  
Cabinet - Z50  
75 x 90x 20 [92]  
Straight Top  
Shelf Headboard  
Interior Bookcases

**Deluxe**  
Cabinet - X50  
75 x 90x 25 [92]  
Curved Top  
Shelf Headboard  
Interior Bookcases

**Ultra**  
Cabinet - U50  
80 x 90.5 x 23 [92]  
Wrap Crown  
Shelf Headboard  
Interior Bookcases  
(only 85" piers)

[Finished Top is included]

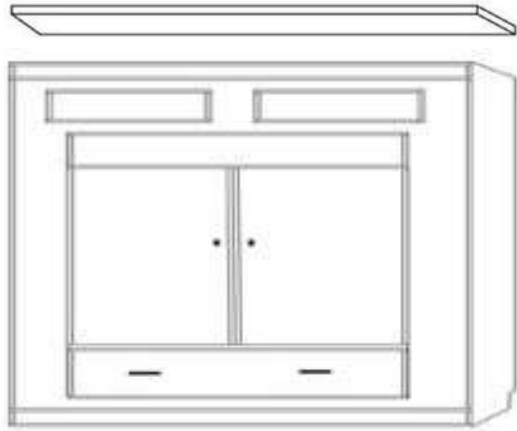

**Barrington Horizontal (BS50)**  
85 x 17 x 70.5 [66]  
All Side Piers = -\$100; 70.5" tall

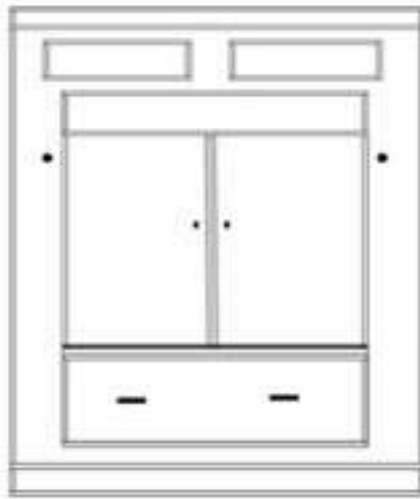

**Barrington Table Bed (BVT50)**  
65 x 90 x 17 [86]  
Table Size: 48w x 40d  
(Available in all 5 Cabinets Options)



**Standard Cabinet also available in:** Full - BV46: 59x85x17 [81] | Twin - BV33: 44x85x17 [81] | Twin XL - BX33: 44x90x17 [86]



black bar    nickel bar    bronze bar    bridge nickel    bridge bronze    bridge black    bridge brass    cody black    cody nickel    cody bronze    cody gold



\* Indicates an upgraded paint finish fee of 10%

Stain finishes are included with no additional fee

\*

\*

\*

**NIGHTSTAND PIER with DOOR**  
2 drawers, pull out tray table,  
Open shelf and upper door



PUF 24x85  
PUQ 24x90

**NIGHTSTAND PIER CABINET**  
2 drawers, pull out tray table,  
With open adjustable shelves

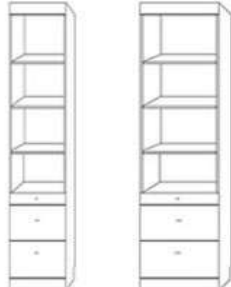

NFS 16x85 PNF 24x85  
NGS 16x90 PNG 24x90

**LATERAL FILES PIER CABINET**  
2 file drawers, pencil drawer  
With open adjustable shelves

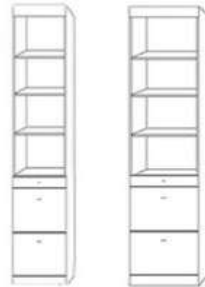

LFS 16x85 PLF 24x85  
LGS 16x90 PLQ 24x90

**3 DRAWER PIER CABINET**  
3 drawers with open adjustable shelves

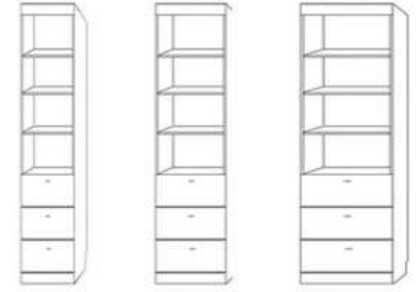

TFS 16x85 PTF 24x85 PGF 32x85  
TGS 16x90 PTQ 24x90 PGQ 32x90



**WARDROBE**  
3 drawers, upper  
door & clothes valet

PWF 24x85  
PWG 24x90



**FILE WARDROBE**  
2 lateral file drawers,  
Pencil drawer with upper  
door & clothes valet

PXF 24x85  
PXG 24x90



**3 DRAWER w/ DOOR**  
3 drawers, upper door

WFS 16x85  
WGS 16x90



**FILE WITH w/ DOOR**  
2 lateral file drawers,  
Pencil drawer  
with upper door

XFS 16x85  
XGS 16x90

**GUEST WARDROBE**  
3 drawers with  
2 upper doors  
& clothes valet

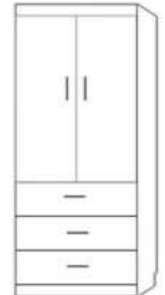

PWU 32x85

**PLEASE NOTE**

**Horizontal Standard**  
Height of piers matches  
height of the wallbed

**Desk Bed no Hutch**  
Height of piers matches  
height of the wallbed

**ROLLING DESK CART**  
On castors, File Cart  
Rolls underneath.  
Finished open back



DC - 63w x 20d x 31h

**ROLLING FILE CART**  
Lateral file drawer,  
medium drawer and a  
pencil drawer on castors.  
Fits underneath Hidden  
Desk beds and Desk Cart.  
Finished back

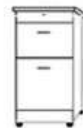

FC 16x16x29

**NIGHTSTAND**  
Flush sides on  
top, baseboard  
notch. 2  
drawers with a  
pencil drawer



NS 24x16x29

**BOOKCASE**



BFS 16x85 PBF 24x85  
BGS 16x90 PBQ 24x90  
BFL 32x85  
BQL 32x90

**DOOR CABINET**

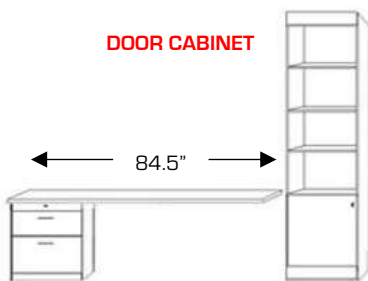

FD - Desk Base  
STRAIGHT Desktop



PCF 24x85  
PCQ 24x90



DFS 16x85  
DQS 16x90

**2 DOOR CABINET**

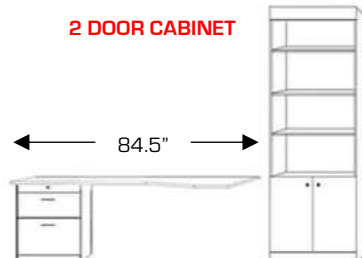

LD - Desk Base  
with SHAPED Desktop

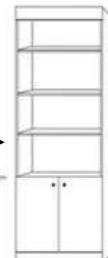

DFL 32x85  
DQL 32x90

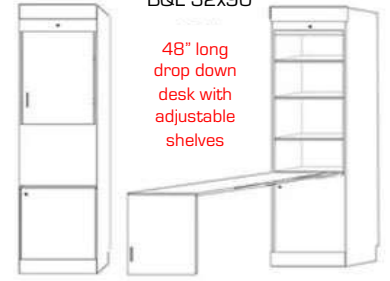

**MURPHY DESK** PAF 24x85

48" long  
drop down  
desk with  
adjustable  
shelves

**Extra's & Add-Ons**

- Add LED Light Bar & USB Charging Station
- Add Extra Shelves
- Add Clothes Hanging Rod to any pier
- Other :

**About the NorCal Collection**

This collection is made in the USA with sustainable hardwoods with veneers. This collection uses "through bolts", has a mattress platform that has internal support struts, and a foundation with 20' of structure material. The NorCal collection uses a piston lift system that has been tested for conditions for 16k cycles with no noticeable change in performance, and the pistons are guaranteed for life.